

NOMENC: MMA-01.280.130

| Pos | Qté | Nom | Description | Matériau |
|-----|-----|----------------|--|----------|
| 1 | 2 | BB-501313.250 | BOULON POUR MOYEU AMOVIBLE-SCR 1/2X1<--->TL 2517 | |
| 2 | 1 | BB-501164.000 | MOYEU AMOVIBLE TL2517 40 | |
| 3 | 1 | BA-563.719.020 | POULIE SPB-190 2 GORGES | |
| 4 | 8 | BS-512.001.225 | DIN 933 VIS M12X25 | |
| 5 | 8 | BS-531.001.200 | DIN 125 RONDELLE M12 | |
| 6 | 2 | BL-801.604.001 | PALIER COMPLET UCDF-208 | |
| 7 | 4 | BS-023.000.810 | DIN 916 VIS DE PRESSION M8X10 | |
| 8 | 8 | BS-502.001.200 | DIN 985 ECROU NYLON M12 | |
| 9 | 10 | BS-531.000.800 | DIN 125 RONDELLE M8 | |
| 10 | 7 | BS-502.000.800 | DIN 985 ECROU NYLON M8 | |
| 11 | 3 | BS-554.100.830 | DIN 603 VIS A BOIS M8X30 | |
| 12 | 1 | MPA-01070.320 | U SUPPORT CAOUTCHOUC | S235J2G3 |
| 13 | 4 | BS-522.101.030 | DIN 7991 VIS A TETE FRAISEE M10X30 | |
| 14 | 1 | MPA-01070.180 | CONTRE LAME | S235J2G3 |
| 15 | 1 | MPA-01280.560 | U SUPPORT CAOUTCHOUC | |
| 16 | 1 | BR-900.001.140 | CAOUTCHOUC D'insonorisation ROTOR ULTRA-PROF | |
| 17 | 1 | BB-040.102.040 | Goupille A RESSORT EPINGLE 2MM | |
| 18 | 4 | BS-512.000.820 | DIN 933 VIS M8X20 | |
| 19 | 2 | BB-011.000.080 | STARLOCK 8MM | |
| 20 | 1 | MPA-01070.020 | POIGNEE FERMETURE GRILLE | S235J2G3 |
| 21 | 5 | BB-221.105.160 | DIN 7337 RIVET ALU 4.8X16 | |
| 22 | 1 | MPA-01280.800 | FIXATION BAVETTE CAOUTCHOUC | |
| 23 | 1 | BR-900.001.370 | BAVETTE CAOUTCOUC ARRIERE | |
| 24 | 2 | BS-501.000.800 | DIN 934 ECROU M8 | |
| 25 | 1 | MPA-01280.400 | SUPPORT | |
| 26 | 2 | MPA-01070.400 | CROCHET FERMETURE GRILLE | S235J2G3 |
| 27 | 1 | MPA-01070.210 | AXE CHARNIERE GRILLE | S235J2G3 |
| 28 | 1 | BR-900.001.340 | BAVETTE CAOUTCHOUC | |
| 29 | 1 | MPA-01280.520 | LATTE BAVETTE CAOUTCHOUC | |
| 30 | 5 | BB-221.104.160 | DIN 7337 RIVET ALU 3.9X16 | |
| 31 | 2 | BR-900.001.330 | CAOUTCHOUC COTE BANDE ARRIERE | |
| 32 | 2 | MPA-01280.530 | LATTE SUPPORT CAOUTCHOUC | |
| 33 | 12 | BB-222.104.120 | RIVETS ALU CONIQUE 3,9 X 12 DIN 7337 B | |
| 34 | 0 | BS-012.401.030 | DIN 961 M10X125X30 10.9 | |
| 35 | 0 | BS-502.001.001 | DIN 985 ECROU NYLON M10X1.25 | |
| 36 | 1 | BU-401.301.000 | KIT-COUTEAUX-ULTRA-PROF | |
| 37 | 1 | MPA-01280.150 | GRILLE DE CALIBRAGE | |
| 38 | 1 | MPA-01280.080 | ROTOR | |
| 39 | 1 | BR-311.21.060 | DIN 6880 CLAVETTE 12X10X60 | |
| 40 | 4 | BS-502.001.000 | DIN 985 ECROU NYLON M10 | |
| 41 | 4 | BS-531.001.000 | DIN 125 RONDELLE M10 | |

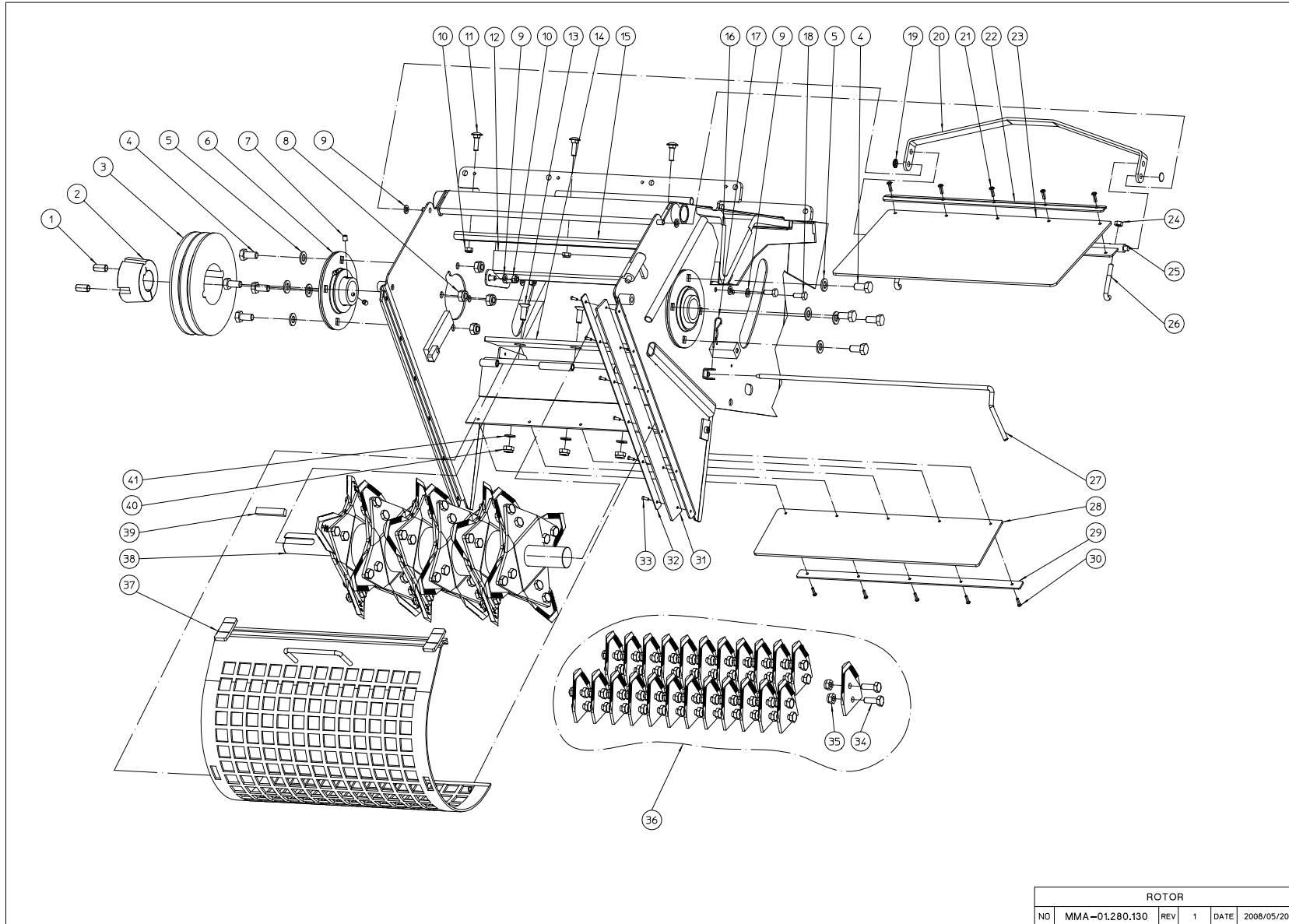

| ROTOR | | | | | |
|-------|----------------|-----|---|------|------------|
| NO | MMA-01.280.130 | REV | 1 | DATE | 2008/05/20 |