

Q 3.7 K

Q 3.7 K

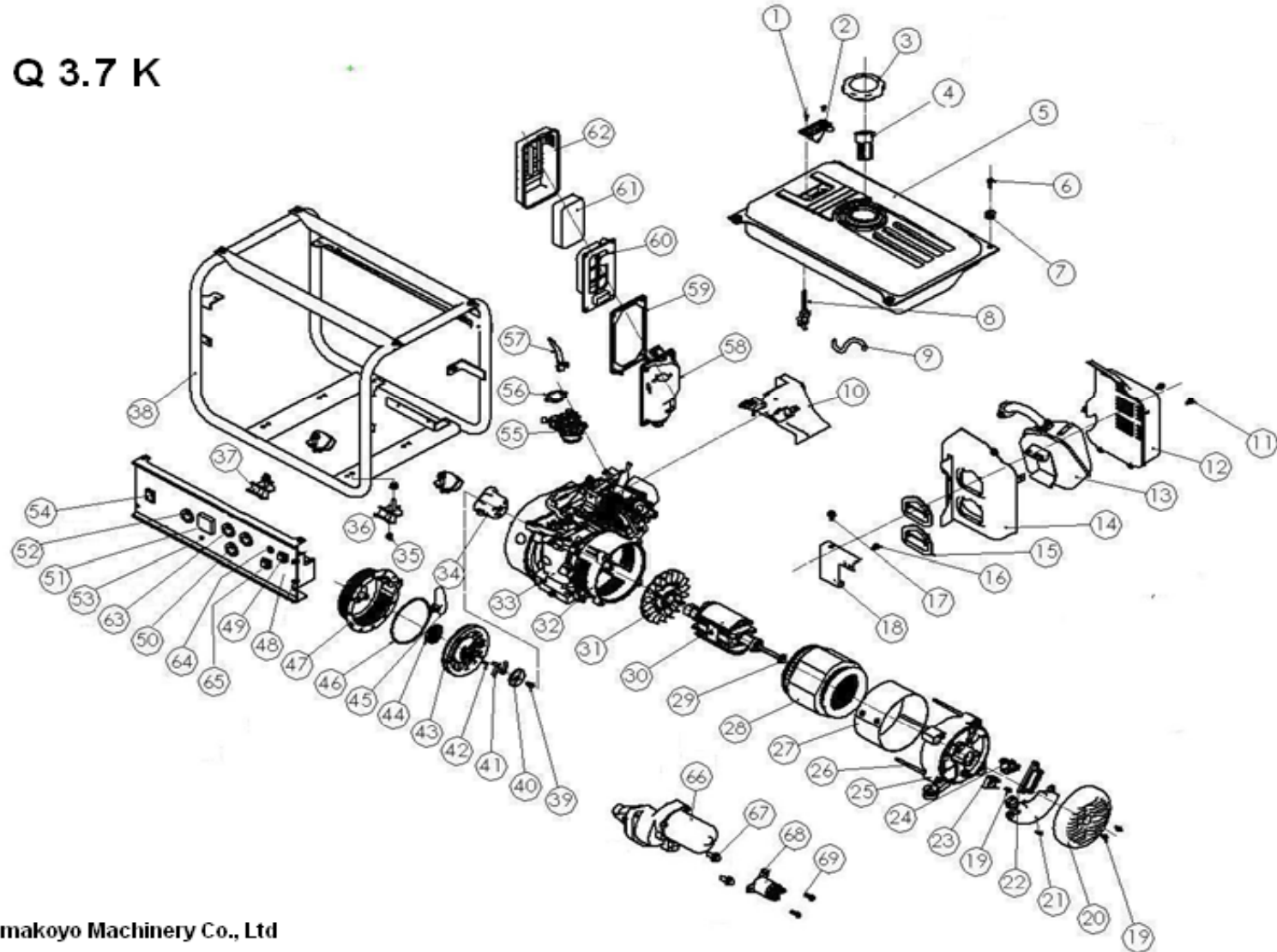

© Yamakoyo Machinery Co., Ltd

Q 3.7 K

No.	P/N	Description	Dealer Price	Distributor Price	No.	P/N	Description	Dealer Price	Distributor Price
1	37Q01	SCREW, M5X10	\$ 1.00	\$ 0.75	26	37Q26	BOLT, FLANGE M6X120	\$ 3.87	\$ 2.90
2	37Q02	GAUGE, FUEL	\$ 3.33	\$ 2.50	27	37Q27	COVER, STATOR	\$ 6.00	\$ 4.50
3	37Q03	CAP, FUEL TANK	\$ 4.67	\$ 3.50	28	37Q28	STATOR, ASSY	\$ 60.00	\$ 45.00
4	37Q04	STRAINER, FUEL TANK	\$ 5.33	\$ 4.00	29	37Q29	BOLT, HEX M10X210	\$ 6.53	\$ 4.90
5	37Q05	FUEL TANK ASSY	\$ 103.33	\$ 77.50	30	37Q30	ROTOR ASSY, PRI	\$ 53.33	\$ 40.00
6	37Q06	SCREW, M6X20	\$ 1.00	\$ 0.75	31	37Q31	FAN, GENERATOR COOLING	\$ 8.27	\$ 6.20
7	37Q07	BUMPER, SPACER	\$ 2.00	\$ 1.50	32	37Q32	COVER ASSY, CRANKCASE	\$ 25.33	\$ 19.00
8	37Q08	VALVE, FUEL SHUT OFF ASSY	\$ 6.40	\$ 4.80	33	37Q33	YK 650 ENGINE	\$ -	
9	37Q09	LINE, FUEL	\$ 2.40	\$ 1.80	34	37Q34	CUP, STARTER	\$ 3.33	\$ 2.50
10	37Q10	COVER, ENGINE	\$ 6.40	\$ 4.80	35	37Q35	NUT, FLANGE M8	\$ 1.00	\$ 0.75
11	37Q11	SCREW, M6X10	\$ 1.00	\$ 0.75	36	37Q36	SHOCK, ABSORBER ALTERNATOR	\$ 6.53	\$ 4.90
12	37Q12	MUFFLER, FRONT COVER	\$ 9.07	\$ 6.80	37	37Q37	SHOCK, ABSORBER ENGINE	\$ 6.53	\$ 4.90
13	37Q13	ASSY, MUFFLER	\$ 14.67	\$ 11.00	38	37Q38	ASSY, FRAME	\$ 106.67	\$ 80.00
14	37Q14	MUFFLER, BACK COVER	\$ 9.07	\$ 6.80	39	37Q39	SCREW, SETTING	\$ 1.00	\$ 0.75
15	37Q15	SEAL, MUFFLER PROTECTOR	\$ 3.73	\$ 2.80	40	37Q40	GUIDE, RATCHET	\$ 2.67	\$ 2.00
16	37Q16	WASHER	\$ 1.00	\$ 0.75	41	37Q41	RATCHET, STARTER	\$ 4.00	\$ 3.00
17	37Q17	SCREW	\$ 1.00	\$ 0.75	42	37Q42	SPRING, RETURN	\$ 1.33	\$ 1.00
18	37Q18	MUFFLER, PROTECTOR	\$ 2.80	\$ 2.10	43	37Q43	REEL, STARTER	\$ 5.33	\$ 4.00
19	37Q19	SCREW, M5X12	\$ 1.00	\$ 0.75	44	37Q44	SPRING, STARTER	\$ 4.00	\$ 3.00
20	37Q20	COVER, GENERATOR END	\$ 6.80	\$ 5.10	45	37Q45	HANDLE, STARTER	\$ 1.33	\$ 1.00
21	37Q21	SCREW, M5X16	\$ 1.00	\$ 0.75	46	37Q46	ROPE	-	-
22	37Q22	REGULATOR ASSY, AUTOMATIC	\$ 29.20	\$ 21.90	47	37Q47	CASE, STARTER	\$ 4.67	\$ 3.50
23	37Q23	DIODE, DC	\$ 9.20	\$ 6.90	48	37Q48	PANEL, CONTROL	\$ 20.00	\$ 15.00
24	37Q24	BRUSH, ASSY	\$ 10.53	\$ 7.90	49	37Q49	LIGHT, INDICATOR	\$ 3.33	\$ 2.50
25	37Q25	HOUSING, RR	\$ 24.00	\$ 18.00	50	37Q50	RECEPTACLE, 120V-30A LOCK	\$ 14.67	\$ 11.00

Q 3.7 K

No.	P/N	Description	Dealer Price	Distributor Price	No.	P/N	Description	Dealer Price	Distributor Price
51	37Q51	VOLTMETER ASSY	\$ 12.67	\$ 9.50	61	37Q61	AIR CLEANER ELEMENT	\$ 2.00	\$ 1.50
52	37Q52	RECEPTACLE, 240V-30A LOCK	\$ 14.67	\$ 11.00	62	37Q62	COVER, AIR CLEANER	\$ 3.33	\$ 2.50
53	37Q53	SWITCH, TOGGLE 120/240 V	\$ 8.67	\$ 6.50	63	37Q63	RECEPTACLE, PRIMARY 120 V	\$ 8.67	\$ 6.50
54	37Q54	SWITCH, ON/OFF KEY ASSY	\$ 20.00	\$ 15.00	64	37Q64	BREAKER, DC CIRCUIT	\$ 12.67	\$ 9.50
55	37Q55	ASSY, CARBURATOR	\$ 33.33	\$ 25.00	65	37Q65	BREAKER, AC CIRCUIT (DOUBLE)	\$ 42.67	\$ 32.00
56	37Q56	GASKET, CARBURATOR	\$ 3.33	\$ 2.50	66	37Q66	MOTOR UNIT, STARTER	\$ 50.00	\$ 37.50
57	37Q57	LEVER, CHOKE	\$ 5.33	\$ 4.00	67	37Q67	BOLT, FLANGE (8X35)	\$ 1.00	\$ 0.75
58	37Q58	HOUSING, AIR CLEANER	\$ 4.67	\$ 3.50	68	37Q68	CONTACTOR ASSY.	\$ 23.33	\$ 17.50
59	37Q59	SEAL AIR CLEANER	\$ 2.67	\$ 2.00	69	37Q69	SCREW-WASHER (5X3)	\$ 1.00	\$ 0.75
60	37Q60	SEPERATOR, AIR CLEANER	\$ 5.33	\$ 4.00					